

BRAKES / FINAL DRIVE

Reverse Kit Service Tips

The following illustration indicates gear position with the Polaris Reverse Kit in the forward and reverse selection.

Installation Tips (Refer to Illustration on page 8.61)

- When installing pinion shaft, be sure the chamfered end of pinion shaft is toward case cover.
- Install chain, top sprocket, bottom option sprocket and wide face pinion gear into case at the same time.
- When installing case cover, be sure that shift fork has slipped into fork groove of reverse gear.

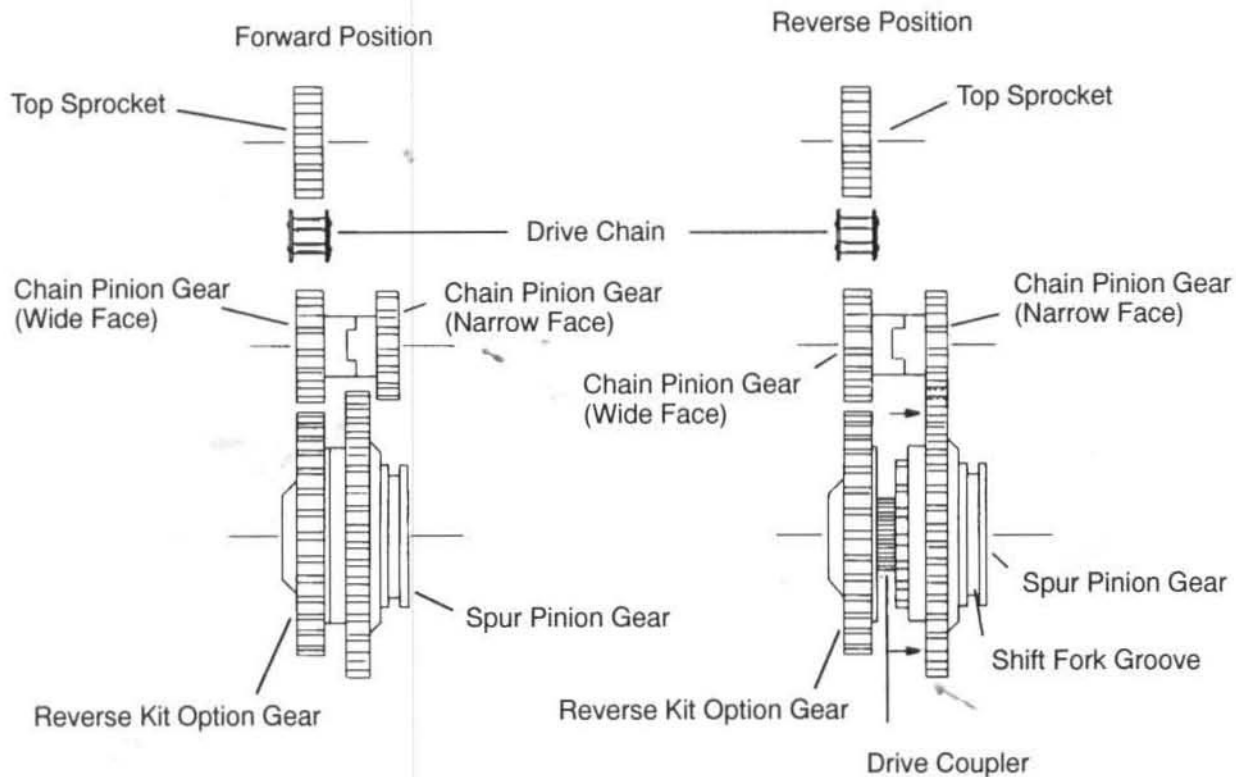

BRAKES / FINAL DRIVE Reverse Kit Maintenance

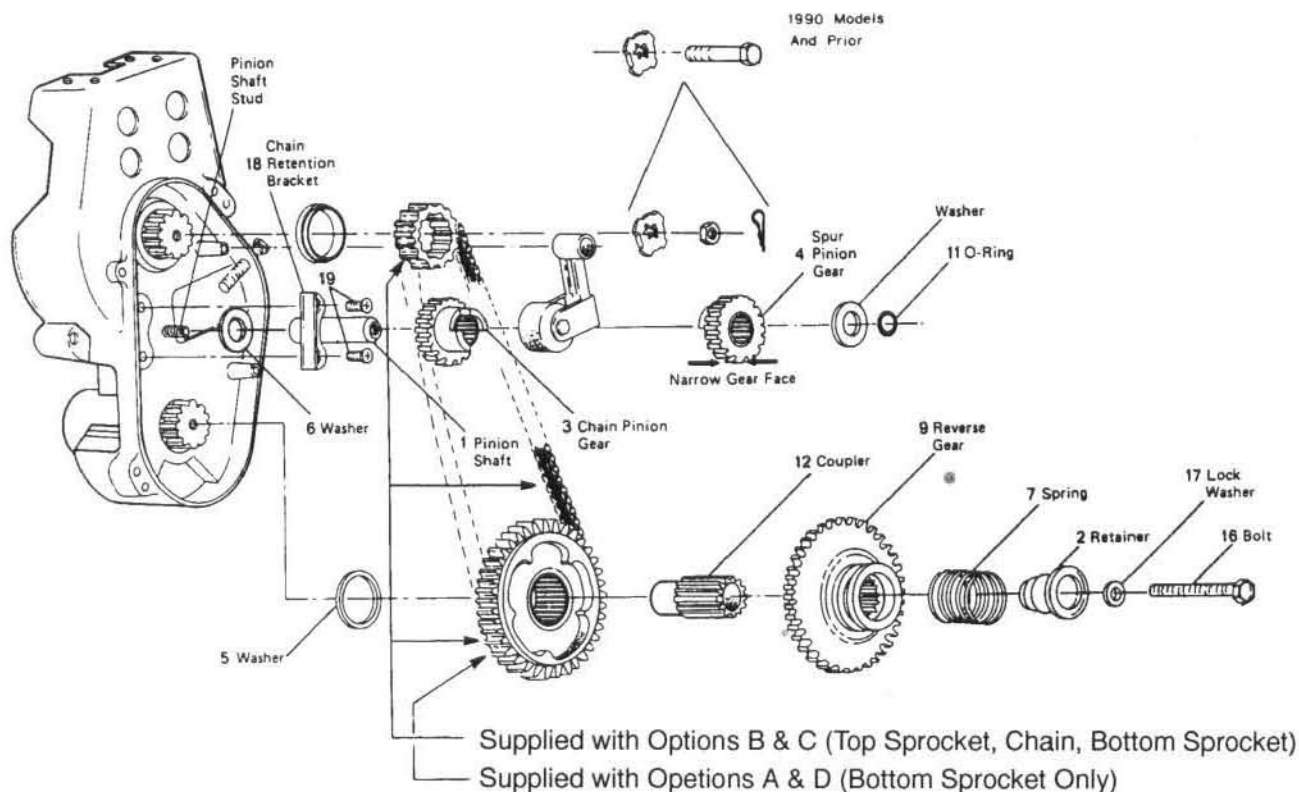

Chain Tension:

1. Maintain proper chain tension by loosening lock nut and applying 20 inch lbs. of torque on adjuster bolt.
2. Loosen adjuster bolt 1/2 turn.
3. Hold adjuster bolt in position and tighten locknut.

Oil Level:

1. Using Polaris chaincase lubricant, maintain proper oil level. Proper level is checked by removing magnetic check plug.
2. Wipe off any metal particles from the magnetic plug. Small amounts of particles will be common on this plug.
3. Add lubricant until a small amount of oil flows from the check plug hole. Do not mix or use other types of lubricant.

Oil Change:

1. Change annually, prior to off season storage.

Adjustment:

1. Due to break in of components and cable stretch, the shifter may need readjustment. Readjust with the shifter in the forward position.
2. Adjust nuts on lower cable end so the endplay movement of the cable housing in the holder on the handlebar is 1/32" (.08 cm). Do not adjust beyond this point.